

SPARE PART CATALOGUE | TSK 50

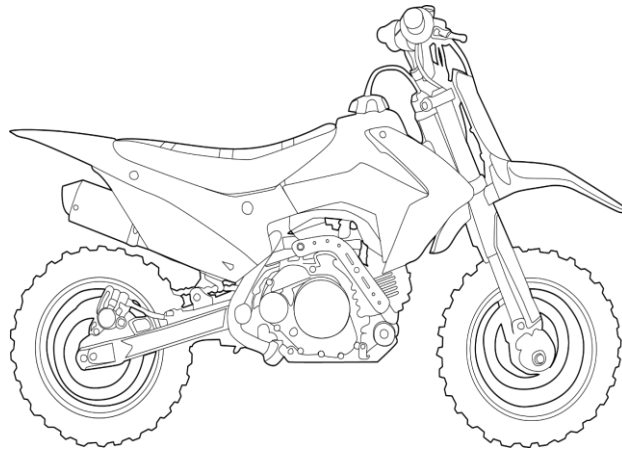

ENGINE

ENGINE TSK 50CC

	POS.	PART NO.	ERP CODE	ENGLISH NAME	QTY
<p>A - Assembly</p>	A	3124		50CC Engine Complete Assembly	
	1		W.050.0073	50cc ENGINE, Full automatic, Electric Start	1
	1-1		1.007.0060	50CC Intake Insulator	1
	1-2		7.010.0030	M6*20 nut	2
	1-3		1.004.0320	50CC Intake Mainfold	1
	1-4		7.010.0040	M6*25 Nut	2
	1-7		1.137.0550	50CC Left Cover	1
	1-8		7.010.0040	M6*25 Nut	1

CARBURETOR

	POS.	PART NO.	ERP CODE	ENGLISH NAME	QTY
<p>A - Assembly</p>	A	3685		Carburetor Complete Assembly	
	1-5		1.016.0101	50CC Carburetor	1
	1-4		7.010.0040	M6*25 Nut	2
	1-8		1.008.0020	Paper Manifold Pad	1
	1-9		1.007.0020	Plastic Manifold Gasket	1
	2		7.150.0010	M6 Hexagonal Locknut	2

AIR FILTER

	POS.	PART NO.	ERP CODE	ENGLISH NAME	QTY
<p>A - Assembly</p>	A	3687		Air Filter Complete Assembly	
	1-6		1.027.0360	50CC Air Filter	1
	1-7			Horse Clip	1
	1-11			Mesh	1

ENGINE'S BOLTS

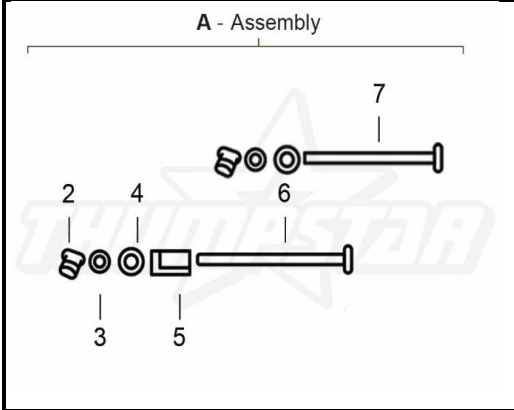

POS.	PART NO.	ERP CODE	ENGLISH NAME	QTY
A	3688		Bolts Complete Assembly	
2		7.140.0020	M8 Nut	2
3		7.220.0020	Φ8 Lock Washer	2
4		7.210.0080	Φ8*Φ16 Washer	2
5		3.330.0170	Φ9*Φ20*10 Spacer	1
6		7.010.0270	M8*105 Bolt	1
7		7.010.0250	M8*95 Bolt	1

MUFFLER

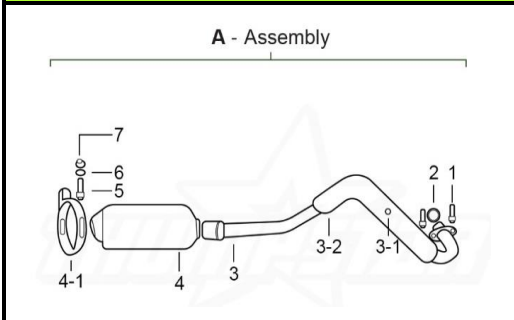

POS.	PART NO.	ERP CODE	ENGLISH NAME	QTY
A	3689		Muffler Complete Assembly	
1		7.070.0070	M6*20 Nut	2
2		1.087.0070	Washer	1
3	3209	1.086.0625	Exhaust Pipe	1
3-1		7.060.0020	M6*10 Nut	2
3-2		1.081.0030	Exhaust Pipe Guard	1
4	3210	1.085.0101	Muffler	1
4-1		1.089.0010	Clamp	1
5		7.070.0170	M8*30 Nut	1
6		7.220.0020	Washer	1
7		7.140.0020	M8 Nut	1

TRIPLE CLAMP SYSTEM

BAR / FORK CLAMPS

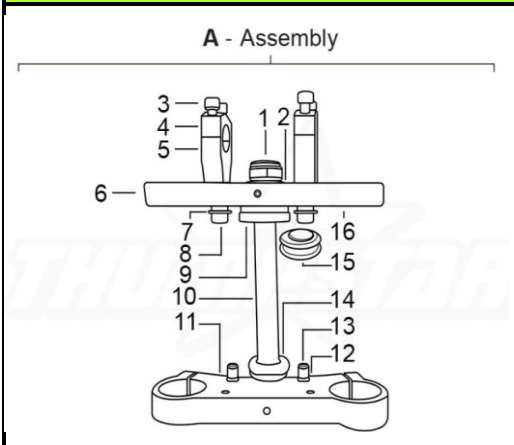

POS.	PART NO.	ERP CODE	ENGLISH NAME	QTY
A	3690		Fork Clamps Complete Assembly	
1		7.210.0270	Φ23*Φ35 Washer	1
2		7.260.0010	Plating	1
3		7.070.0160	M8*25 Nut	4
4	3340	4.080.0230	Φ22 CNC Handlebar Holder Up	2
5	3341	4.090.0260	Φ22 CNC Handlebar Holder Down	2
6	3338	4.060.0260	CNC Φ41*160 Upper Clamp	1
7		7.220.0030	Φ10 Washer	2
8		7.010.0410	M10*1.25*35 Nut	2
9	3342	7.270.0020	Φ48 Nut	1
10	3337	4.100.0025	212mm Stem	1
11	3339	4.070.0230	CNC Φ45*160 Lower Clamp	1
12		7.220.0020	Φ8 Washer	2
13		7.020.0140	M8*16 Nut	2
14		7.210.0290	Φ24*Φ37 Washer	1
15	3155	4.400.0010	Steer Bearing (Six Bowls)	1
16		7.210.0130	Φ10*Φ18*1.5 Nut	2

FRAME SYSTEM

FRAME

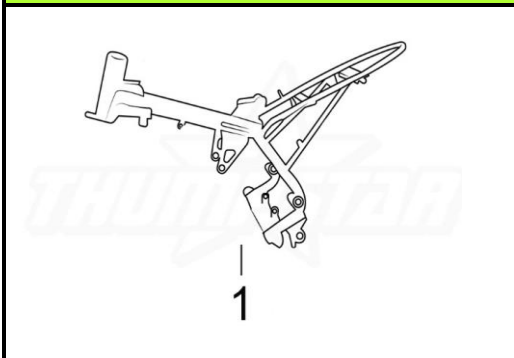

POS.	PART NO.	ERP CODE	ENGLISH NAME	QTY
1	3691	3.500.1250	Frame	1

FRAME ASSEMBLY PARTS

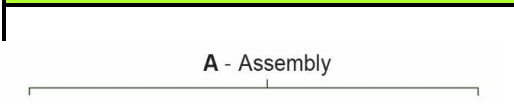

POS.	PART NO.	ERP CODE	ENGLISH NAME	QTY
A	3691		Frame Parts Complete Assembly	
2	3164	3.730.0060	Bracket	2
3		7.050.0020	M6*16 Nut	3

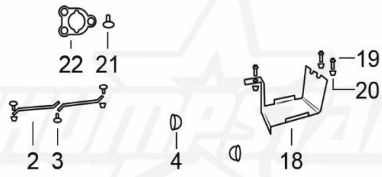

4	3232	3.240.0030	φ25 Rubber	2
18	3157	3.630.0130	Battery Case	1
19		7.010.0020	M6*16 Nut	3
20		7.140.0010	M6 Nut	2
21		7.050.0010	M6*10 Nut	1
22	3161	3.520.0072	Bracket Key Contact	1

BASH PLATE	POS.	PART NO.	ERP CODE	ENGLISH NAME	QTY
-------------------	------	----------	----------	--------------	-----

<p style="text-align:center;">A - Assembly</p>	A	3692		Bash Plate Complete Assembly	
	5		7.010.0010	M6*12 Hexagon Flange Bolt	2
	6		3.540.0160	Engine Protection	1

FRAME SPARE PARTS

FOOTPEG	POS.	PART NO.	ERP CODE	ENGLISH NAME	QTY
----------------	------	----------	----------	--------------	-----

<p style="text-align:center;">A - Assembly</p>	A	3247		Footpeg Complete Assembly	
	7		3.570.0070	Foot Rest	2
	8		7.240.0020	Φ8*40 Pin	2
	9		7.230.0030	Φ2.5*16 Cotter Pin	2
	10		7.210.0080	Φ8*Φ16 Washer	2
	11	3218	3.590.0020	Spring	2

STAND	POS.	PART NO.	ERP CODE	ENGLISH NAME	QTY
--------------	------	----------	----------	--------------	-----

<p style="text-align:center;">A - Assembly</p>	A	3219		Stand Complete Assembly	
	12	3252	3.620.0010	90mm Side Stand Spring	1
	13		3.610.0030	180mm Bike Stand	1
	14		7.030.0010	M10*25 Nut	1
	15		7.210.0180	Φ12*Φ24*1.5 Washer	1

CHAIN ROLLER ASSEMBLY	POS.	PART NO.	ERP CODE	ENGLISH NAME	QTY
------------------------------	------	----------	----------	--------------	-----

<p style="text-align:center;">A - Assembly</p>	A	3135		Chain Roller Complete Assembly	
	10		7.210.0080	Φ8*Φ16 Washer	1
	16		2.060.0010	Chain Tensioner	1
	17	3031	7.390.0010	Bearing	2
	18			Split Pin	1

CHAIN ADJUSTER		POS.	PART NO.	ERP CODE	ENGLISH NAME	QTY
<p>A - Assembly</p>		A	3640		Chain Adjuster Complete Assembly	
		13		3.690.0090	Φ15*31 Chain Adjuster	1
		14		7.180.0040	M8 Nut	2
		15		7.020.0080	M8*60 Nut	2

SWINGARM SYSTEM

SWINGARM		POS.	PART NO.	ERP CODE	ENGLISH NAME	QTY	
<p>2</p>		2	3693	3.510.0270	Swingarm	1	

SWINGARM ASSEMBLY		POS.	PART NO.	ERP CODE	ENGLISH NAME	QTY
<p>A - Assembly</p>		A	3694		Swingarm Complete Assembly	
		1	3254	7.390.0090	Bearing	2
		3	3159	3.340.0400	Φ16*Φ12*138mm Spacer	1
		4		3.130.0200	M10*1.25*200 Axle	1
		5		7.140.0030	M10*1.25 Nut	1

CHAIN COVER		POS.	PART NO.	ERP CODE	ENGLISH NAME	QTY
<p>A - Assembly</p>		A	3234		Chain Cover Complete Assembly	
		8		7.170.0020	M6 Nut	4
		9		7.050.0010	M6*10 Nut	4
		10	3483	2.140.0010	Fixing Part	4
		11		7.060.0020	M6*10 Nut	4
		12		2.030.0045	Chain Cover	1

CHAIN SLIDER		POS.	PART NO.	ERP CODE	ENGLISH NAME	QTY
<p>A - Assembly</p>		A	3336		Chain Slider Complete Assembly	
		6		7.090.0040	M6*16 Nut	1
		7		3.350.0030	Chain Slider	1

SUSPENSION SYSTEM

FORK ASSEMBLY		POS.	PART NO.	ERP CODE	ENGLISH NAME	QTY
<p align="center">A - Assembly</p>	A	3138			Fork Complete Assembly	
	1	3221	3.270.1450		550mm*41*45 Right Front Fork	1
	1-1	3221			550mm*41*45 Left Front Fork	1
	2		7.110.0020		M5*10 Nut	6
	3		7.210.0040		Φ6*Φ12 Washer	2
	4	3695	3.290.0030		Right Fork Guard	1
	4-1	3695			Left Fork Guard	1
	5		7.100.0100		4.8*14 Nut	2

FORK GUARD		POS.	PART NO.	ERP CODE	ENGLISH NAME	QTY
<p align="center">A - Assembly</p>	A	3696			Fork Guard Complete Assembly	
	2		7.110.0020		M5*10 Nut	6
	3		7.210.0040		Φ6*Φ12 Washer	2
	4	3695	3.290.0030		Right Fork Guard	1
	4-1	3695			Left Fork Guard	1
	5		7.100.0100		4.8*14 Nut	2

REAR SUSPENSION		POS.	PART NO.	ERP CODE	ENGLISH NAME	QTY
<p align="center">A - Assembly</p>	A	3139			Rear Suspension Complete Assembly	
	6		7.010.0420		M10*1.25*40 Nut	1
	7		3.280.0051		260mm*Φ10*150mm Rear Shock	1
	8		7.010.0450		M10*1.25*45 Nut	1
	9		7.140.0030		M10*1.25 Nut	2

OPERATING SYSTEM

HANDLE BAR		POS.	PART NO.	ERP CODE	ENGLISH NAME	QTY
	A	3697			Handle Bar Complete Assembly	
	2		4.010.0015		560-570 Handlebar	1
	11	3069	6.040.0030		Handle Bar	1

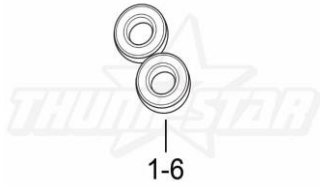

CHAIN	POS.	PART NO.	ERP CODE	ENGLISH NAME	QTY
--------------	------	----------	----------	--------------	-----

	13	3148	2.010.0490	420 10x43T = 88L Black Chain	1

SPROCKET	POS.	PART NO.	ERP CODE	ENGLISH NAME	QTY
-----------------	------	----------	----------	--------------	-----

	A	3147		Sprocket Complete Assembly	
	11		2.040.0240	420*76*43 Sprocket	1
	12		7.070.0160	M8 * 25 Nut	4

TRAINING WHEEL	POS.	PART NO.	ERP CODE	ENGLISH NAME	QTY
-----------------------	------	----------	----------	--------------	-----

	17	3709		Training wheels Complete Assembly	1 set

CDI	POS.	PART NO.	ERP CODE	ENGLISH NAME	QTY
------------	------	----------	----------	--------------	-----

	A	82		CDI Complete Assembly	
	1		5.090.0010	CDI	1
	2		8.010.0010	Zip tie	1

IGNITION COIL	POS.	PART NO.	ERP CODE	ENGLISH NAME	QTY
----------------------	------	----------	----------	--------------	-----

	A	3157		Ignition Coil Complete Assembly	
	4		5.060.0010	12V Relay	1

IGNITION KEY SWITCH

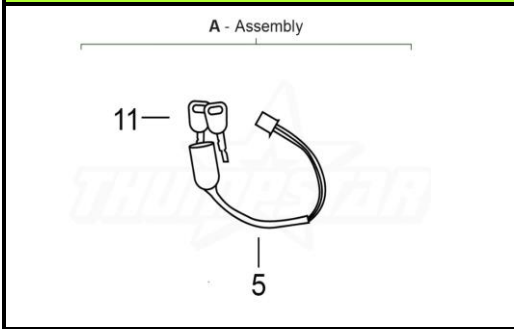

POS.	PART NO.	ERP CODE	ENGLISH NAME	QTY
A			Ignition Key Switch Complete Assembly	
5	3156	5.150.0020	Ignition Switch	1
11			Key	2

PLASTICS ASSEMBLY

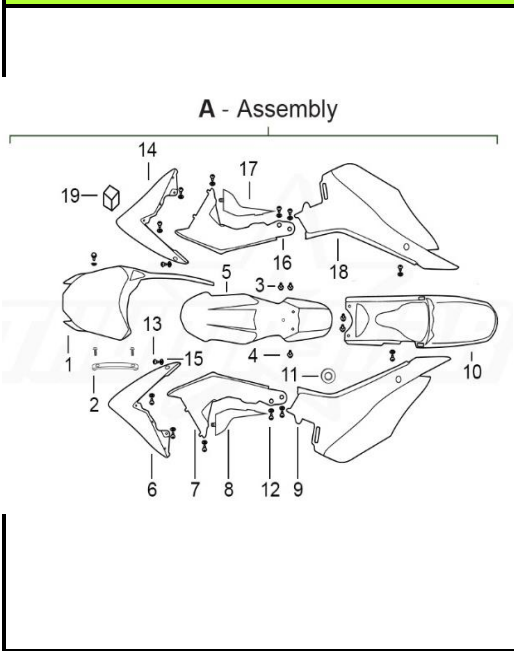

POS.	PART NO.	ERP CODE	ENGLISH NAME	QTY
A			Plastic Complete Assembly	
1	3149	6.110.0220	Front Number Plate	1
2	3233	6.110.0111	Clip	1
3		7.010.0010	M6*12 Hexagon flange bolts	
4		7.010.0020	M6*16 Hexagon flange bolts	
5		6.130.0162	Front Mud Guard	1
6		6.150.0161	Front left shroud	1
7	3226	6.170.0100	Front left Plastic	1
8	3230	6.170.0110	Left front panel	1
9	3228	6.190.0130	Left rear side panel	1
10	3223	6.140.0150	Rear Mud Guard	1
11		7.050.0020	Hexagon socket head cap screws	
12		7.100.0030	4.2 * 12 (big head) Cross recessed pan head tapping screws	
14		6.160.0151	Front right shroud	1
15		7.050.0010	M6*10 Hexagon socket head cap screws	
16	3227	6.180.0080	Front left Plastic	1
17	3231	6.180.0090	Left front panel	1
18	3229	6.200.0120	Left rear side panel	1
19	3429	1.088.0040	Rubber Pad	1

FRONT AND REAR MUD GUARD

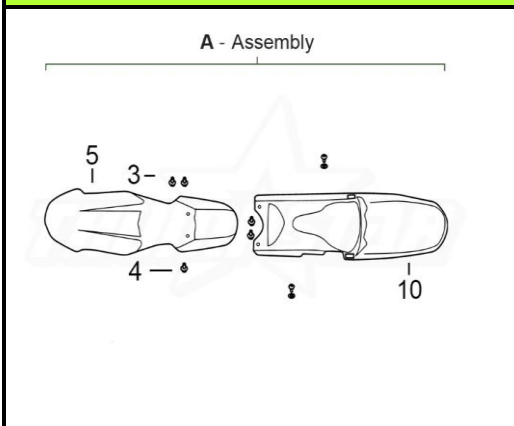

POS.	PART NO.	ERP CODE	ENGLISH NAME	QTY
A	3712		Front and Rear Mud Guard Complete Assembly	
3		7.010.0010	M6*12 Hexagon flange bolts	4
4		7.010.0020	M6*16 Hexagon flange bolts	1
5		6.130.0162	Front Mud Guard	1
10	3223	6.140.0150	Rear Mud Guard	1

FUEL DELIVERY SYSTEM

TANK ASSEMBLY

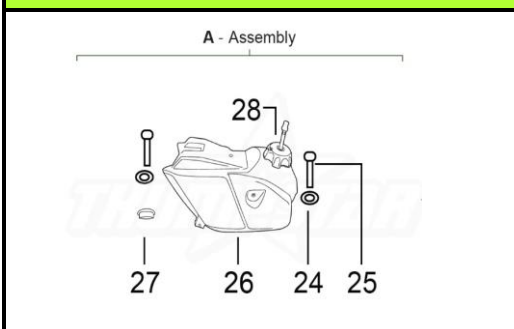

POS.	PART NO.	ERP CODE	ENGLISH NAME	QTY
A	3713		Tank Complete Assembly	
24		3.340.0350	Φ6.5*Φ9-Φ20*15-17mm Spacer	2
25		7.010.0050	M6*30 Nut	2
26	3151	6.080.0210	Fuel Tank	1
27		7.190.0010	M6 Nut	1
28	3052	6.090.0170	Fuel Cap	1

